

1 Platform :

Capacity 160 kg
All aluminium platform

2 Upper control box :

Electrical controls
Emergency stop switch
Control enable switch

3 Lower controls :

Emergency stop switch
Emergency platform lowering control
Outrigger indicator lights
Contact key

4 Breakdown platform lowering control

Power system :

5 Access to electrical control box
(AC Models)
or to battery 12V - 95Ah / 5h
+ charger (DC Models)

Loading system :

6 Loading pivot and stop bracket
7 T-handle
8 Roller
9 Lift and tie-down ring

Transport system :

10 Handle
11 Steering castor wheel
12 Press on solid tyres
13 Front wheels
14 Forklift pockets

15 Lifting system :

Profile aluminium masts
Raising by hollow rod hydraulic cylinder and lifting
leaf chains
Mast back up cables

Electro-hydraulic system :

16 Access door to hydraulic circuit
Hydraulic power unit
Tank / Oil filtration system
Electrical control box (DC Models)

17 Outriggers
18 Outrigger sockets
19 Bubble level
20 All steel chassis

OPTIONS AVAILABLE UPON REQUEST

Constant improvements and engineering progress make it necessary that Manitowoc Crane Group reserves the right to make specification, equipment or price changes without notice (02-2003).

1 Working height max. 8.28 m

2 Platform height max. 6.28 m

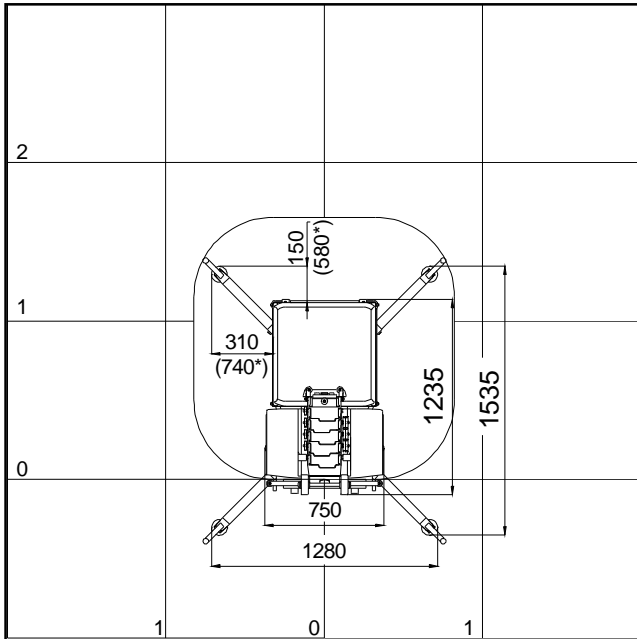

*= outside use

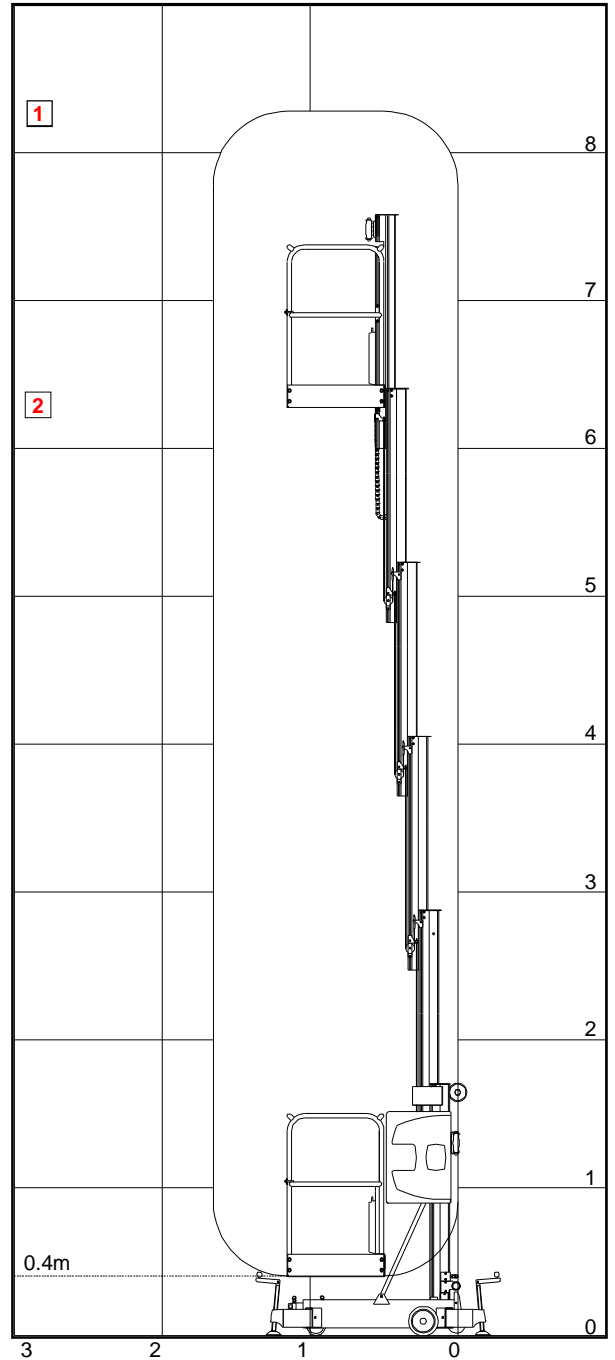

Dimensions :

	Machine Inside use	Machine Outside use
Height	1.72 m	1.72 m
Width	0.75 m	0.75 m
Width with outriggers	1.28 m	2.14
Length	1.24 m	1.24 m
Length with outriggers	1.53 m	2.40 m
Platform	0.66 x 0.66 m	0.66 x 0.66 m
Weight	330 kg (AC) 345 kg (DC)	340 kg 355 kg

Warranty : 12 Months parts

12 Months labour

60 Months structure

See warranty information for any limitations or restrictions that may apply.